

AL10R Work

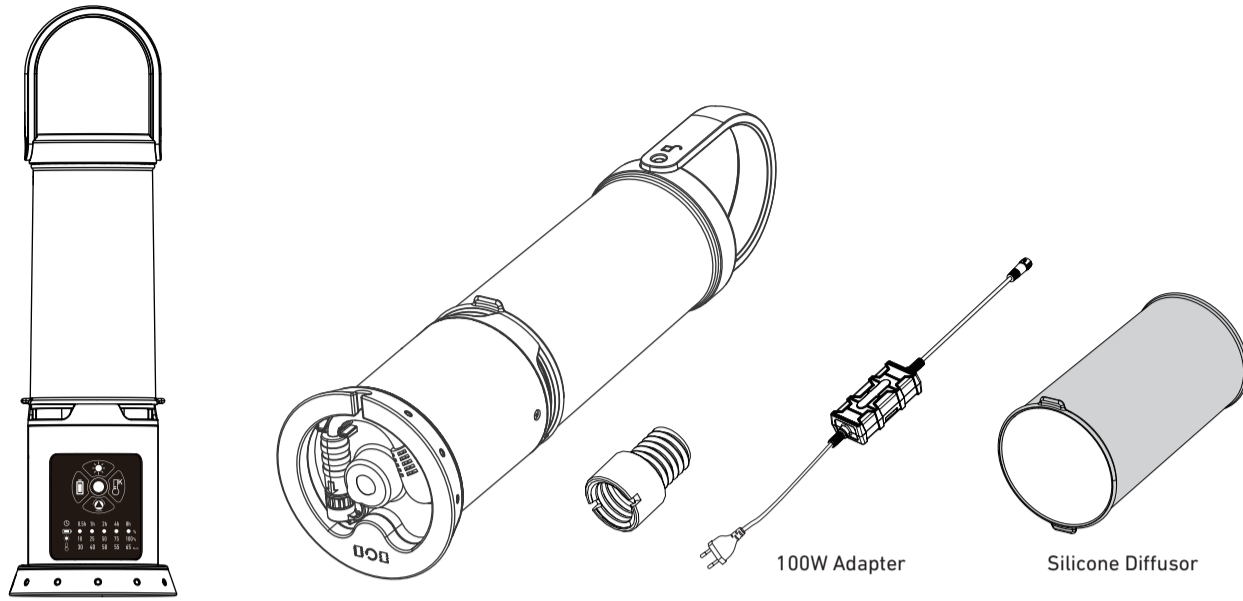

LED Module: AL10R CCT LED Module

This product contains light sources of energy efficiency class E
 Dieses Produkt enthält eine Lichtquelle der Energieeffizienzklasse E
 Este producto contiene una fuente luminosa de la clase de eficiencia energética E
 Ce produit contient une source lumineuse de classe d'efficacité énergétique E

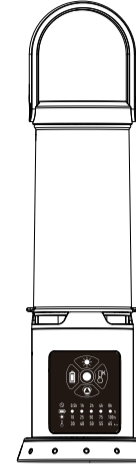

Dust and Waterproof

Product	IP Class
	IP67
	IP44
	IP20

Charging System

Connection

- Insert the charging cable into the lamp's charging port.
- Connect the 100W adapter to a power outlet.

Disconnection

- Disconnect the 100W adapter from the power outlet.
- Remove the charging cable from the lamp's charging port.

Battery Level Indicators:

- <20%: 1 lit, 4 empty
- 20-40%: 2 lit, 3 empty
- 40-60%: 3 lit, 2 empty
- 60-80%: 4 lit, 1 empty
- ≥80%: 5 lit
- 100%: 5 lit

High Temperature Protection

1		≥55°C		X No Charging
2		<55°C		✓ Charging

Battery Indicator

Off 1xClick

Battery Level Indicators:

- Green
- <10%: 1 lit, 4 empty
- 10-20%: 2 lit, 3 empty
- 20-40%: 3 lit, 2 empty
- 40-60%: 4 lit, 1 empty
- 60-80%: 5 lit
- ≥80%: 5 lit

Minimum distance from lighted objects

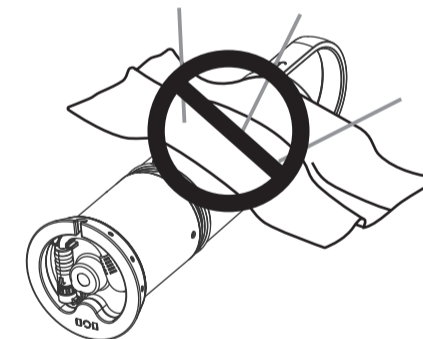

Detachable Silicone Diffusor

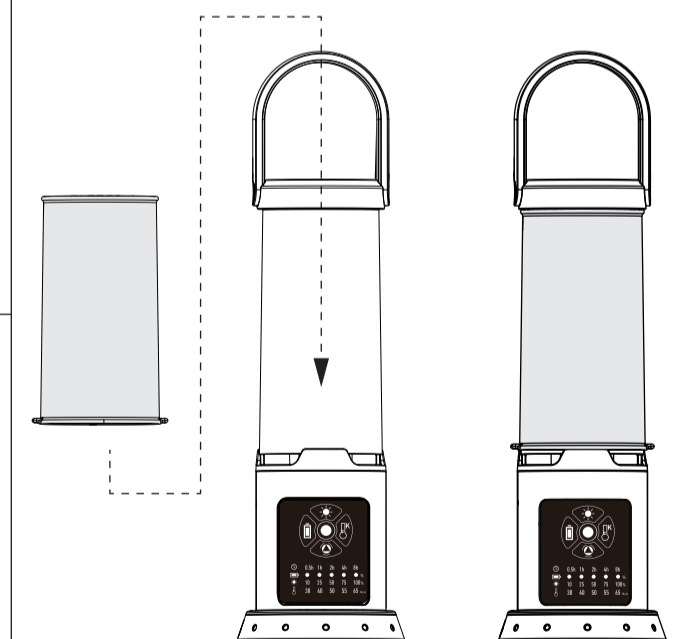

Transportation Lock

Off

Hold ≥5s

2xBlink

Lock

Hold ≥5s

2xBlink

Unlock

Detachable Cap with Handle

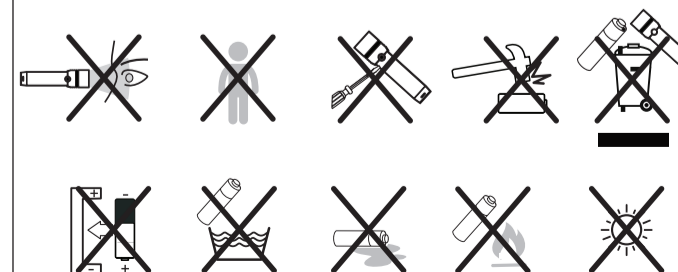
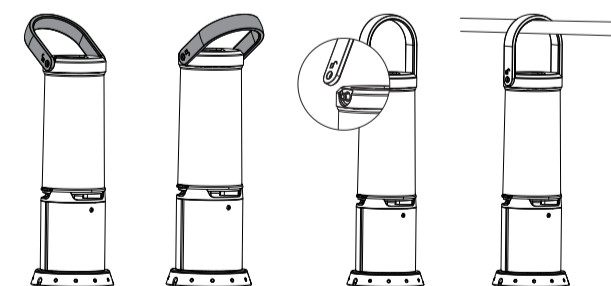

Ledlenser GmbH & Co. KG
 Kronenstrasse 5-7 • 42699 Solingen • Germany
 Phone +49 212/5948-0 Fax +49 212/5948-200
 info@ledlenser.com



LEDLENSER AL10R Work

Operation

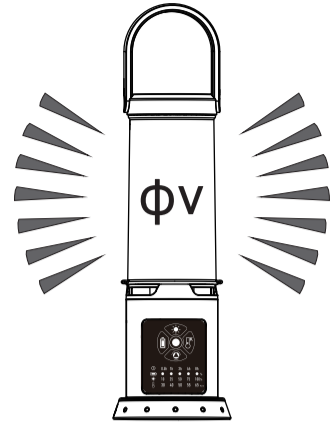
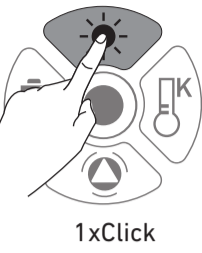
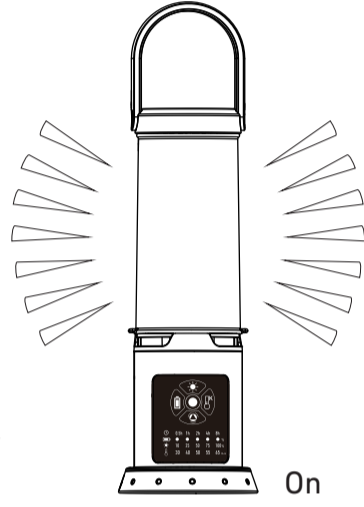
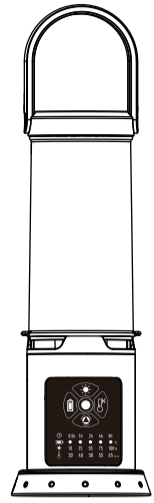

Luminous flux
10% ⇌ 100%

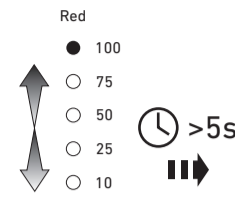

Runtime

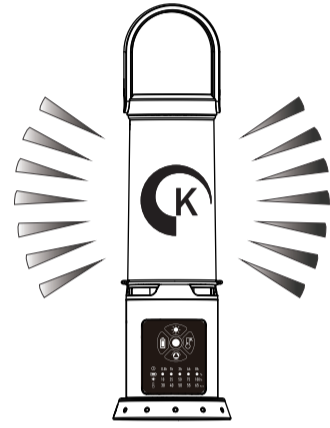
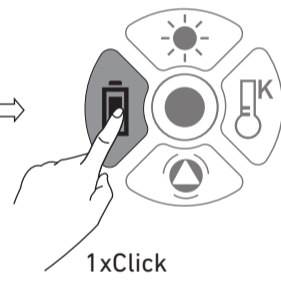
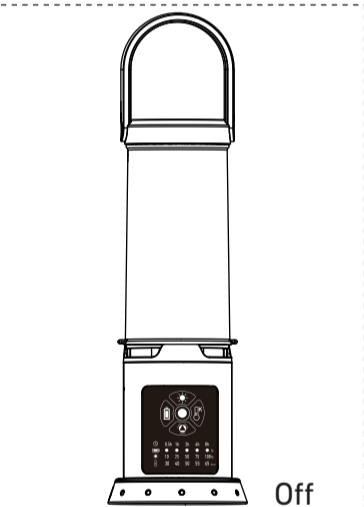

Color temperature
3000K ⇌ 6500K



Runtime

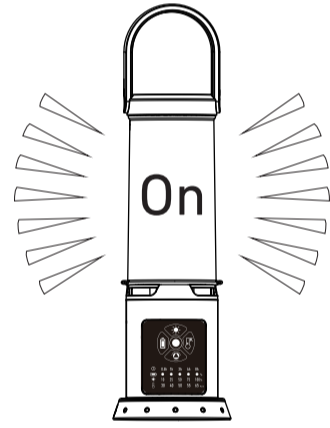
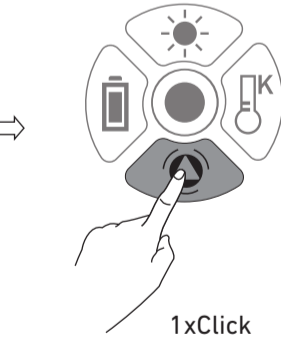
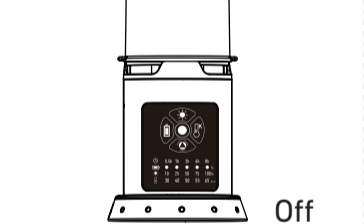

Battery indicator

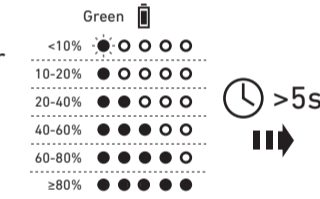

Runtime

